

JOHN LOUIS HOME

Solid Wood Home Storage Solutions



Installation Instructions

12in. & 16in. Deep Accessory Tower

JLH-610, 610W, 611CH, 615, 618, 620, 620W, 623CH, 624, 625

PARTS LIST:



Quantity: 2 72 in. Tower Side

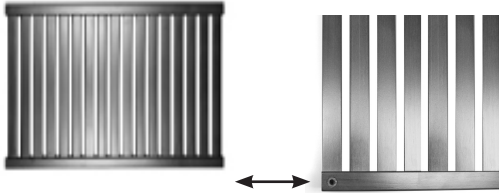

Quantity: 1 26.25 in. Tower Top Shelf

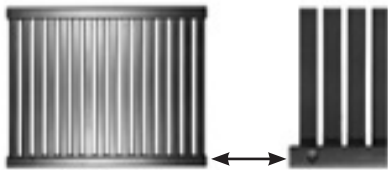

Quantity: 1 24 in. Tower Bottom Cam Shelf with Nameplate



Quantity: 6
Tower Bracket

Quantity: 2
Shelf mounting L-Clip

Quantity: 4
Mushroom Cap



Quantity: 4
Cam Lock Nut



Quantity: 4
Cam Bolt



Quantity: 4
Barrel Bolt



Quantity: 4
Barrel Nut



Quantity: 1
Tower Stabilizer Bar



Quantity: 16
#8 1 1/2 in.



Quantity: 2
#4 3/4 in.



Quantity: 16
Wall Anchor



Quantity: 6
#6 3/4 in.



Quantity: 2
#8 1 in. (Flat)



Quantity: 1
Allen wrench

REQUIRED TOOLS FOR INSTALLATION:

The following tools will be needed to assemble and install your John Louis Home Solid Wood Accessory Tower:

- Pencil
- Tape Measure
- Stud Finder
- Level
- Phillips Screwdriver
- Powered Drill with Phillips Bit

CONTACT US:

For questions concerning missing or damaged parts, technical specs and / or assembly help, please contact John Louis Home Customer Service at:

Email: service@johnlouishome.com

Web: www.johnlouishome.com

Phone: 1.800.480.6985 (Mon-Fri, 8am-4pm, Central)

JOHN LOUIS HOME

Solid Wood Home Storage Solutions

STEP 1: Tower Assembly

1. Place tower sides down with grooves facing up.
2. Insert cam bolts at tower bottom hole locations (Do not over tighten).
3. Insert tower sides into tower bottom (24in. shelf with nameplate).
4. Insert cam nuts into tower bottom shelf with arrow facing bolt hole.
5. Secure by turning cam nuts clockwise to tighten.
6. Repeat for opposite tower side.

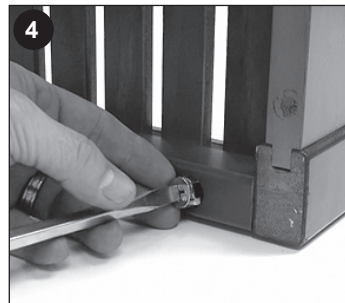
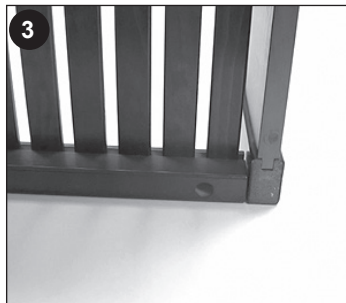
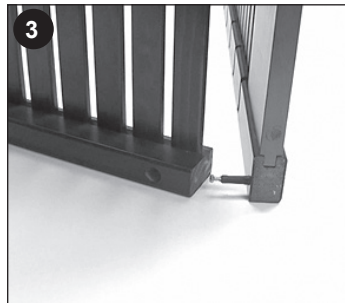
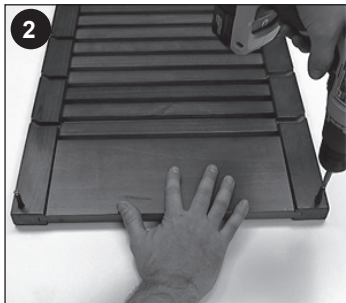
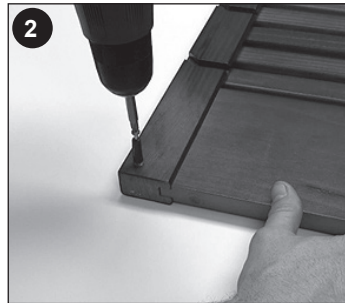

7. Place tower top (26.25 in. shelf) into notches at top of tower.
8. Insert barrel nuts into tower sides with slot in a vertical position.
9. Insert barrel bolts into tower top.
10. Flush tower top with tower side & tighten with allen wrench provided (nut position may need adjustment).

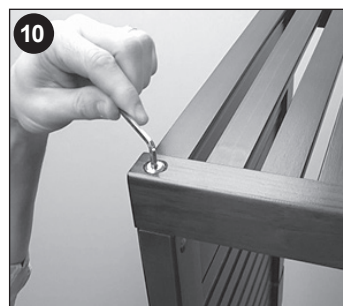
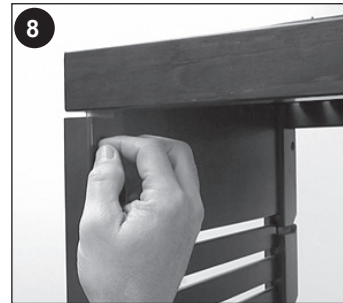
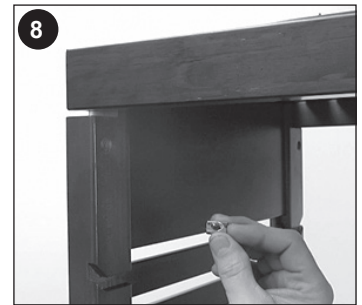

11. Place tower face down (nameplate typically designates tower front).
12. Place top tower bracket between 1st & 2nd groove.
13. Place middle tower bracket between 8th & 9th groove.
14. Place bottom tower bracket between last groove & tower bottom.
15. Repeat for opposite side.
16. Secure top and bottom brackets to tower using #8 3/4 in. screws.

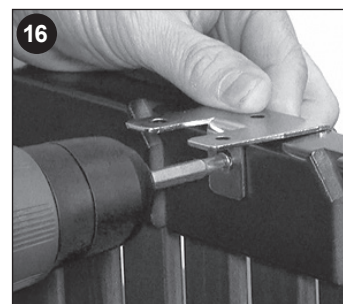
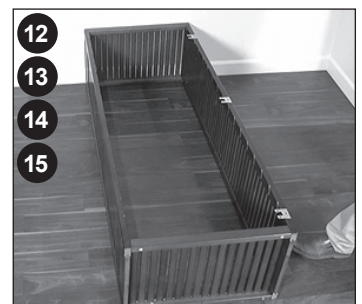

Note: The purpose of the Tower Stabilizer Bar is to hold the tower sides parallel prior to securing against back wall. It is installed in conjunction with the 2 middle tower brackets.

17. Align the Tower Stabilizer Bar with the middle pair of tower brackets.
18. With Tower Stabilizer ends properly nested between the pair of tower brackets, secure using #8 - 1in. screws.
19. The Tower Stabilizer provides proper distance alignment during installation. It can be left in permanently or removed after installation is completed. If removed, replace the #8 - 1in. screws with remaining #8 - 3/4in. screws.

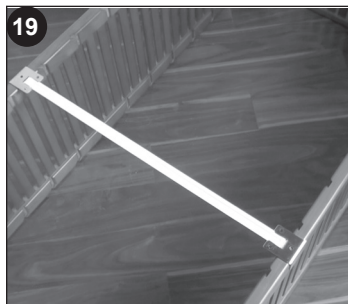
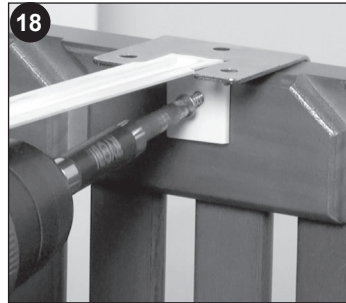
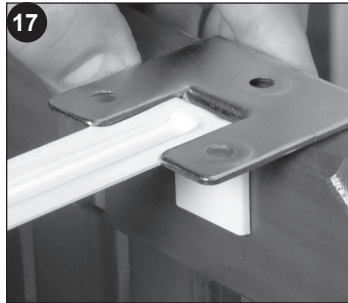

IMPORTANT!
DO NOT use Tower Stabilizer as a means for lifting or positioning the Tower into place!

STEP 2: Mounting Tower to the Wall

The Accessory Tower is designed to be mounted up off the floor onto the back wall. The recommended placement height is 84 in. However, the tower can be placed at any height desired.

Please note that proper installation of the Accessory Tower **REQUIRES** it to be mounted flush to a back wall.

It is recommended to install a minimum of 1 tower side into wall stud. Use wall anchors provided when no stud is present.

1. Measure up from the floor & mark desired height location (Towers are typically placed at 84 in.).
2. Draw a 2 ft. level line at your marked location (This represents the location of the tower top).



You will space 2 L-clips equidistant within the 24 in. level line. (Install into wall studs when possible. If no stud is present, use wall anchors provided.)

3. Center L-clip to screw hole with the level line & mark hole locations.
4. Install wall anchors if no stud is present.
5. Secure L-clip to the wall using #8 1 1/2in. screws at hole locations.
6. Repeat for remaining L clip location.

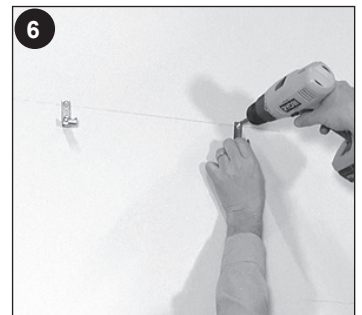
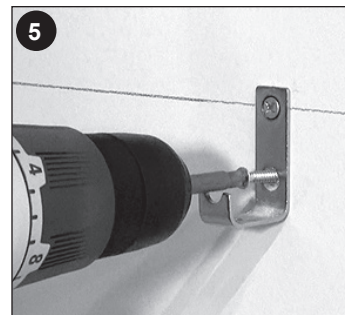
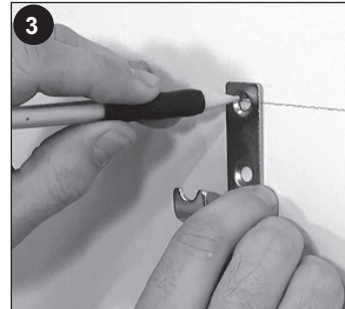

7. Place tower onto L-clip hardware.
8. Place level against tower side & plumb level tower (Tower interior width should be 24 1/8 in.).
9. Mark all tower bracket hole locations on wall.
10. Remove tower.

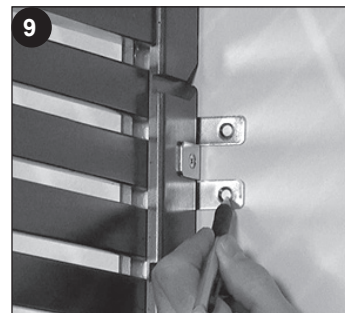
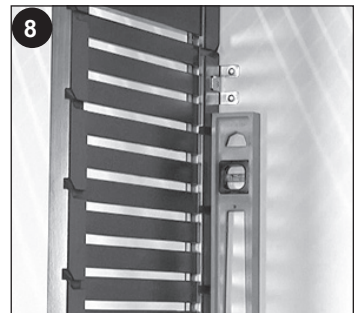

11. Install wall anchors at tower bracket hole locations if no stud is present.
12. Place tower back onto L-clip hardware and align with hole locations.

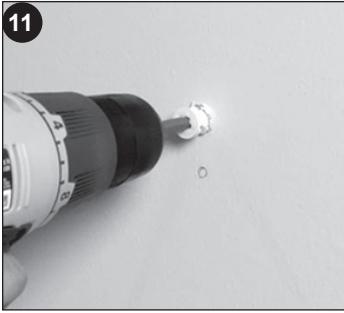

13. Double-check that tower is plumb.
14. Secure brackets to the wall using # 8 1/2 in. screws at all hole locations.

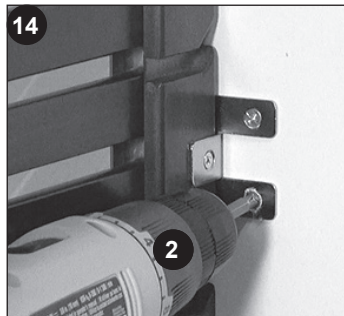

15. Secure tower to L-clips using #4 3/4 in. screws.
16. Insert mushroom caps into barrel nut holes.

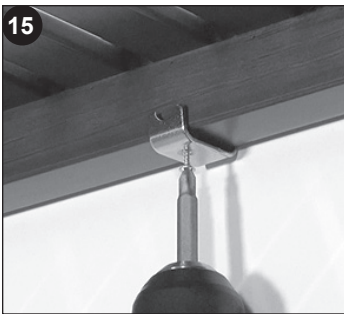

JOHN LOUIS HOME

Solid Wood Home Storage Solutions

For additional product information including step-by-step Installation Videos, Frequently Asked Questions, Storage Tips and more, please visit: johnlouishome.com/resources