

JOHN LOUIS HOME

Solid Wood Home Storage Solutions



Installation Instructions

12in. & 16in. Pull Out Laundry Basket

JLH-734, 737

PARTS LIST:



Quantity: 1
Wire Basket



Quantity: 2
Glide



Quantity: 4
Basket Clip



Quantity: 1
Glide Template



Quantity: 4
Laundry hamper



Quantity: 4
#6 3/4 in. screw

Required Tools For Installation:

The following tools will be needed to assemble and install your John Louis Home product:

- Pencil
- Phillips Screwdriver
- Powered Drill with Phillips Bit (optional)

Contact Us:

For questions concerning missing or damaged parts, technical specs and / or assembly help, please contact John Louis Home Customer Service at:

Email: service@johnlouishome.com

Web: www.johnlouishome.com

Phone: 1.800.480.6985 (Mon-Fri, 8am-4pm, Central)

STEP 1: Attaching Glides To Tower

NOTE: THE SLIDE ATTACHES TO THE 2ND HORIZONTAL BAR.

1. Position basket at desired height location.

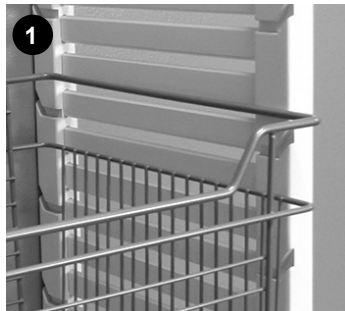
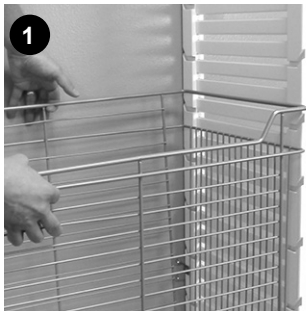

2. Note the area between the tower grooves where the basket lines up.
3. Mark the location & remove basket.

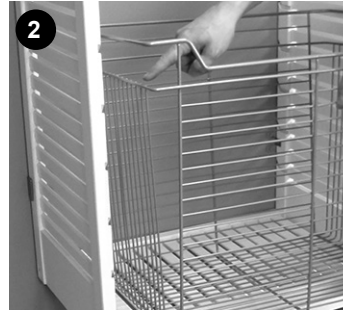

4. At the marked location, align the template provided between the tower grooves.
5. Mark the location using the center hole on the template.
6. Repeat on back rail and on opposite tower side.

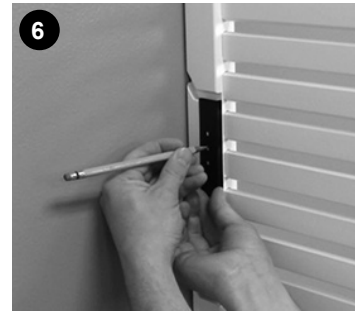
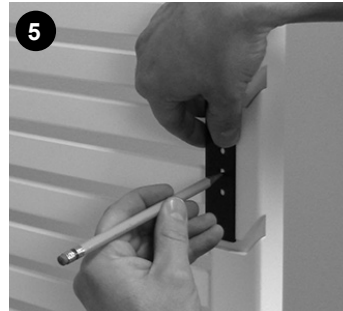

7. Fully extend the glide & move lever to separate glide.

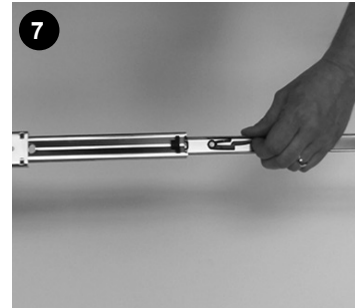
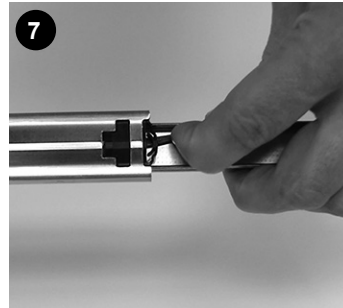

8. Position the glide at the marks with the open end facing outward.
9. Secure the glide using #6 3/4 in. screws.
10. Repeat for opposite tower side.



STEP 2: Attaching The Basket

1. Re-attach slides.
2. Insert plastic clips into glide.
3. Rotate clip & push top to snap clip into lock position.
4. Repeat at all clip locations.

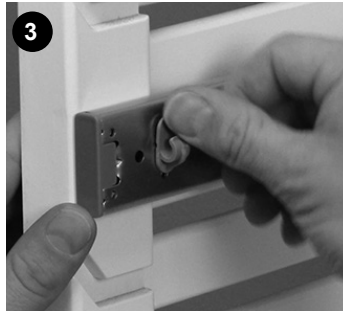
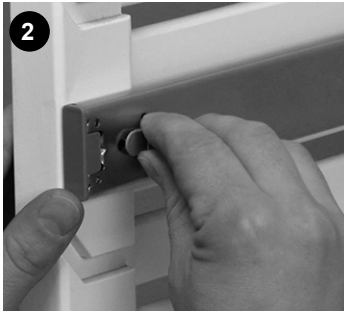
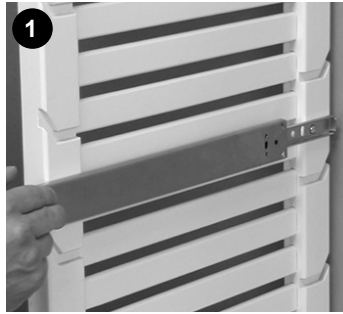
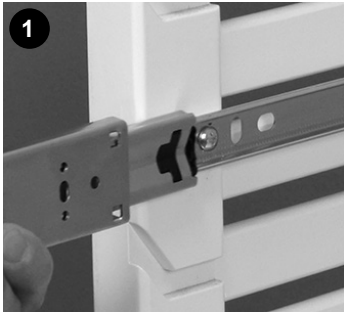

5. Fully extend 1 glide.
6. Place basket onto clips (using 2nd horizontal bar).
7. Fully extend 2nd glide & place basket onto clips (using 2nd horizontal bar).
8. Move basket in & out to ensure glides move freely & are locking into place.

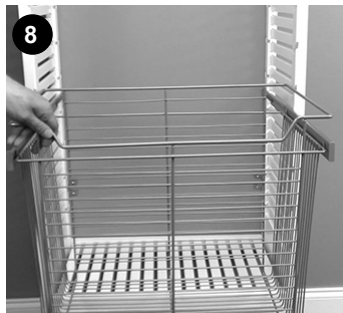
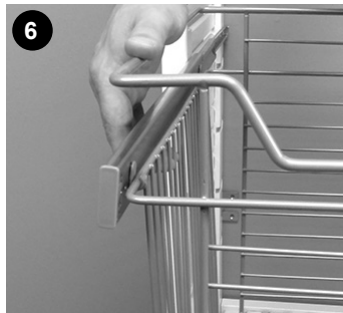
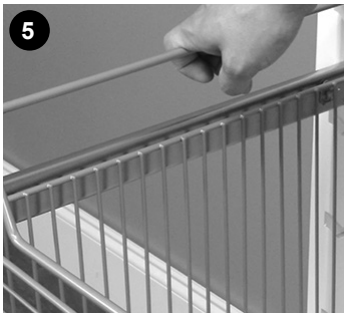

9. Insert hamper bag into basket.
10. Secure bag over top horizontal rail.



JOHN LOUIS HOME

Solid Wood Home Storage Solutions

For additional product information including step-by-step Installation Videos, Frequently Asked Questions, Storage Tips and more, please visit: johnlouishome.com/resources