

# JOHN LOUIS HOME

Solid Wood Home Storage Solutions



Installation Instructions

## **12in. & 16in. Pull Out Pant Rack**

JLH-730, 731

## PARTS LIST:

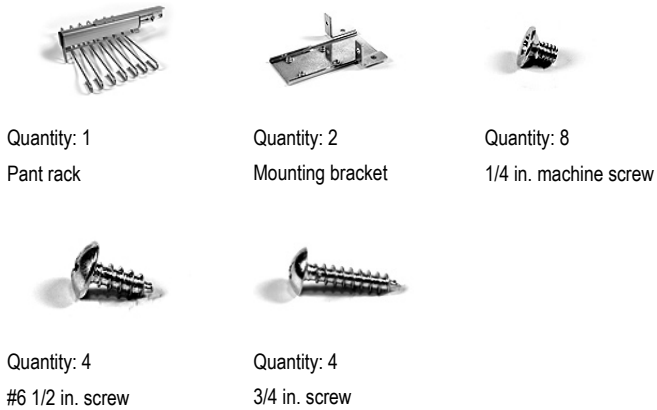

## Required Tools For Installation:

The following tools will be needed to assemble and install your John Louis Home product:

- Pencil
- Phillips Screwdriver
- Powered Drill with Phillips Bit (optional)

## Contact Us:

For questions concerning missing or damaged parts, technical specs and / or assembly help, please contact John Louis Home Customer Service at:

Email: [service@johnlouishome.com](mailto:service@johnlouishome.com)

Web: [www.johnlouishome.com](http://www.johnlouishome.com)

Phone: 1.800.480.6985 (Mon-Fri, 8am-4pm, Central)

## STEP 1: Attach Brackets To Slide

1. Fully extend the glide.
2. Move lever upon one side and down on opposite side and pull to release glide.

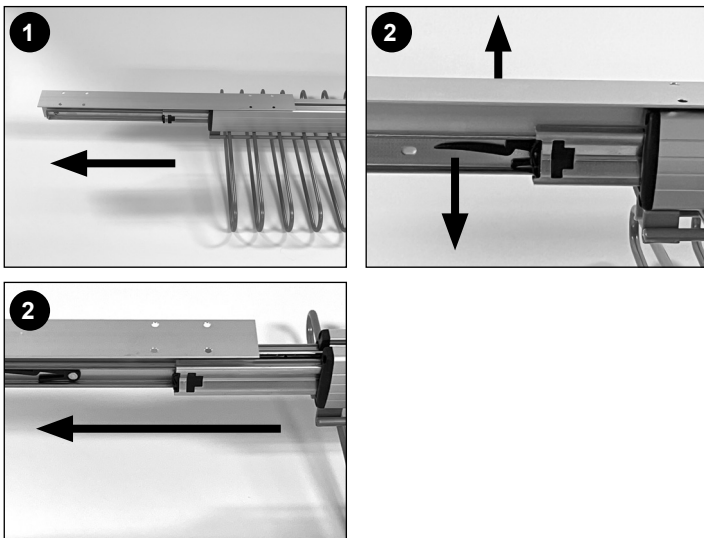

3. Place bracket facing down with flanges outward.
4. Place glide onto bracket & align screw holes.
5. Secure with 1/4 in. machine screws.

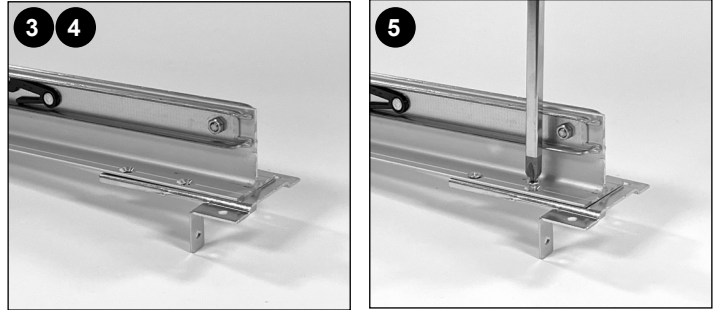

6. Insert bracket under opposite side.
7. Secure with 1/4 in. machine screws.

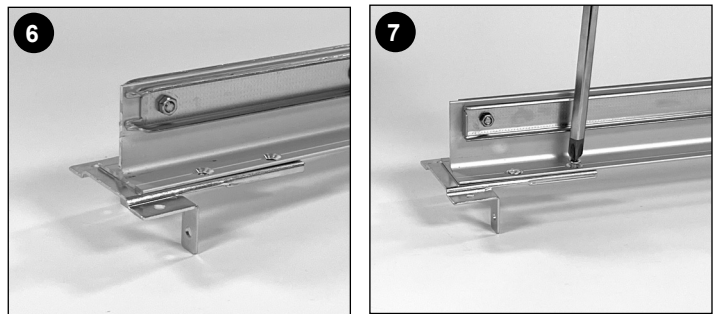

## STEP 2: Attach Pant Rack To Shelf

1. Place slide in the desired location.
2. Secure using #6 3/4 in. screws at upper hole locations.
3. Secure using #6 1/2 in. screws at lower hole locations.
4. Repeat for opposite end.

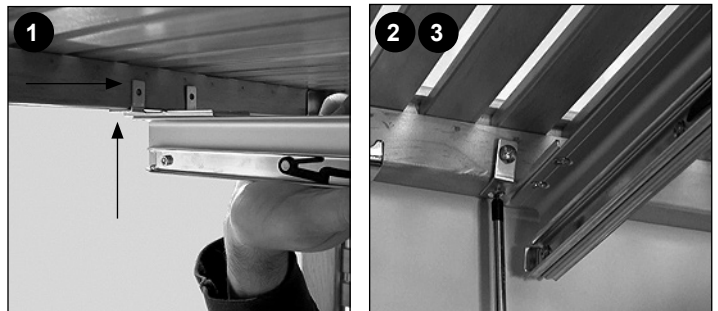

5. Insert Rack onto glide.
6. Move in & out to lock glide.

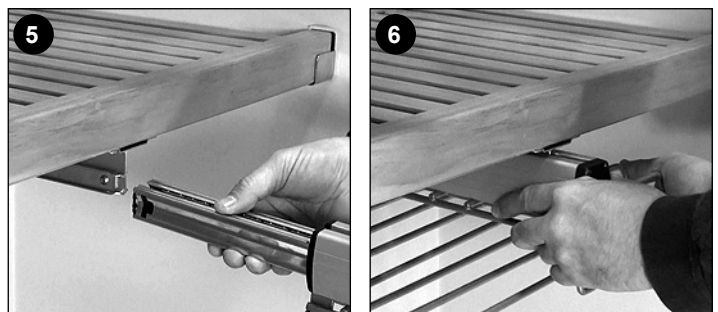

## STEP 3: How To Reverse Rack Loading

---

1. Extend glide & insert phillips head screwdriver. Requires thin Screwdriver.
2. Hold nut in place & remove screw.
3. Repeat for opposite end.

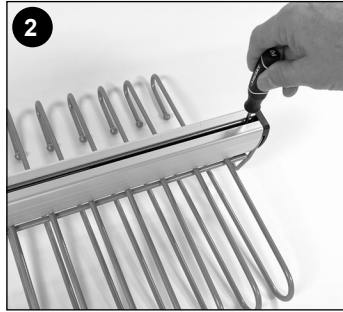
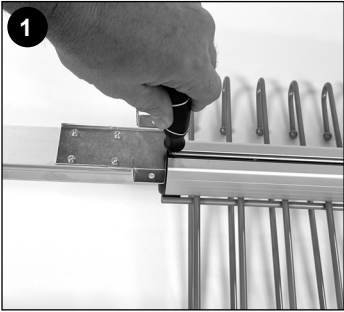

4. Remove rack, rotate, replace & align screw holes.
5. Replace & tighten screws.

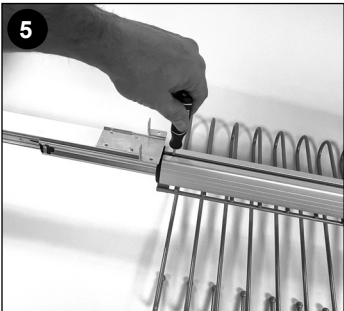
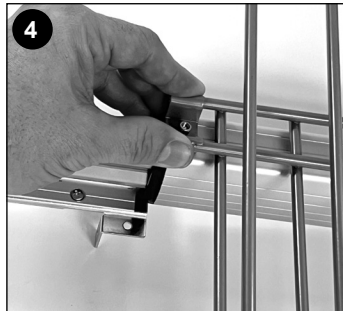
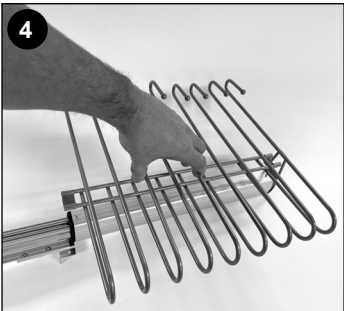

# JOHN LOUIS HOME

Solid Wood Home Storage Solutions

---

For additional product information including step-by-step Installation Videos, Frequently Asked Questions, Storage Tips and more, please visit: [johnlouishome.com/resources](http://johnlouishome.com/resources)